



1

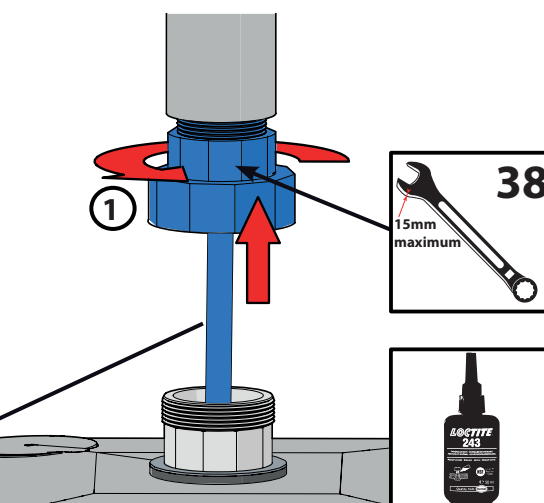

Diagram illustrating the tightening torque for the base plate. The base plate is shown being lowered onto the robot arm structure. The diameter of the base plate is indicated as $\varnothing 2.38"$. A red arrow points down to the base plate. A circular inset shows a close-up of the base plate with a red arrow indicating the tightening direction (clockwise) and the text "x8" indicating the number of bolts. A table in the bottom right corner specifies the tightening torque for the base plate.

Part	Tightening torque
Base plate	6 N.m

3

52

38

15mm maximum

Tighten

Hold

3



CLAC!



Suspended



Cable clamp

x4

●

5

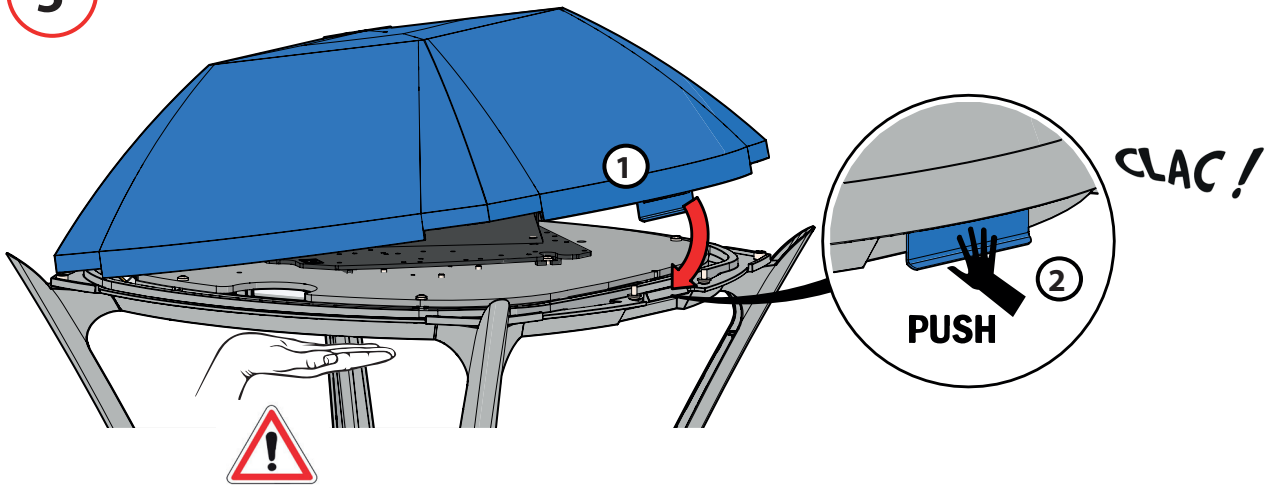

Maintenance

1

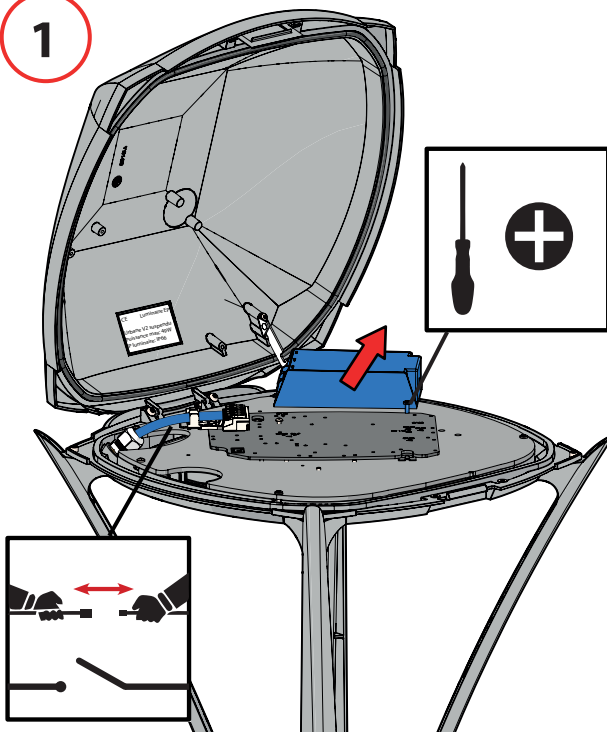

2

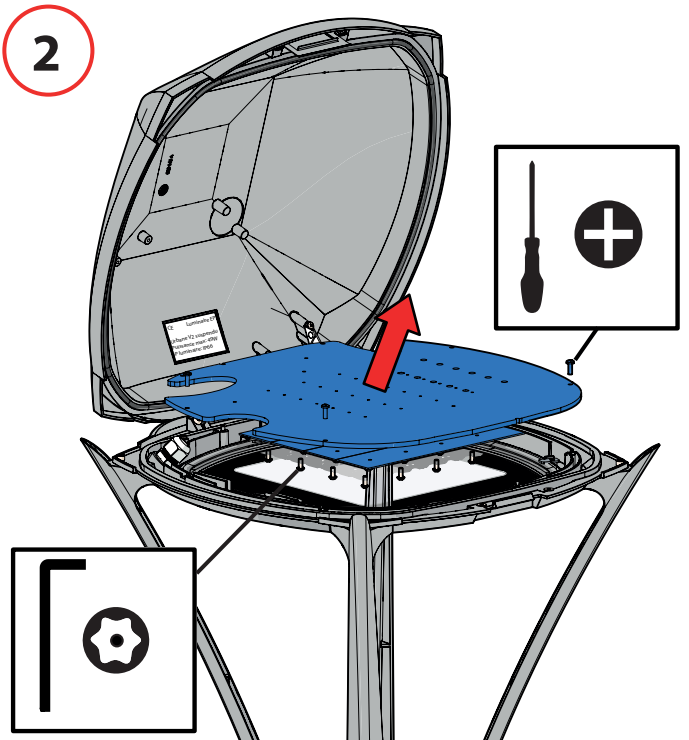

Cleaning

